

**Description** : Alkaline High Voltage Battery

**Nominal Voltage** : 6Volts

**Nominal Dimensions** : Ø10.22mm×16.5mm

**Terminal** : Nickel plated flat contacts - protruded  
red(+); recessed black (-)

**Jacket** : Metal jacket

**Internal Connection** : Pressure

**Applications** : Remote controller

**Average Weight** : 4.0g

**Date Code** : Unless otherwise specified, each batteries will carry a numeric year code and analogue month code

**Shelf Life** : Not less than 90% of the service capacity within first year. , not less than 85% of the service capacity with third year storage at  $22 \pm 3 \text{ }^\circ\text{C}$   
40-80 %RH

**Insulation** : 5MΩ min.

**Resistance**

**Close Circuit Voltage** : 4.7 Volts (min.)(load resistor 200Ω  
at  $22 \pm 3 \text{ }^\circ\text{C}$  for 0.1 to 2 seconds)

**Current Drain** : Under 15mA pulse, 0.5mA  
continuous

**Nominal Service Life** : 74hrs (at 10kΩ load)  
(to 3.0V at  $22 \pm 3 \text{ }^\circ\text{C}$ )

**Average Service Capacity** : 38mAh(at 10kΩ load)  
(to 3.0V at  $22 \pm 3 \text{ }^\circ\text{C}$ )

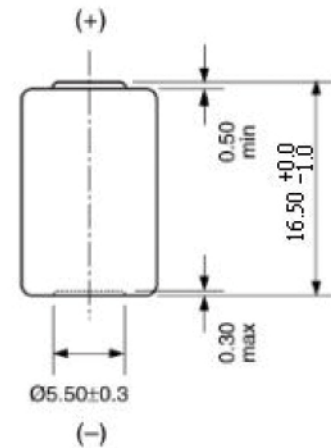
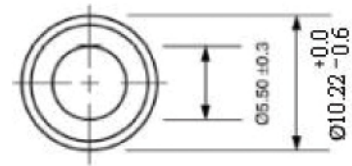

Unit : mm

**Typical Discharge characteristics at  $22 \pm 3 \text{ }^\circ\text{C}$**

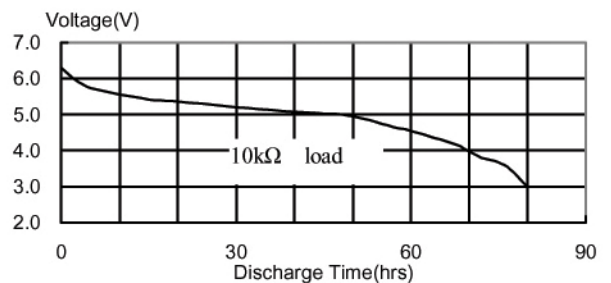

**No publication or circulation of data to third parties without consent of VARTA Consumer Batteries**